

EXPLODED VIEW

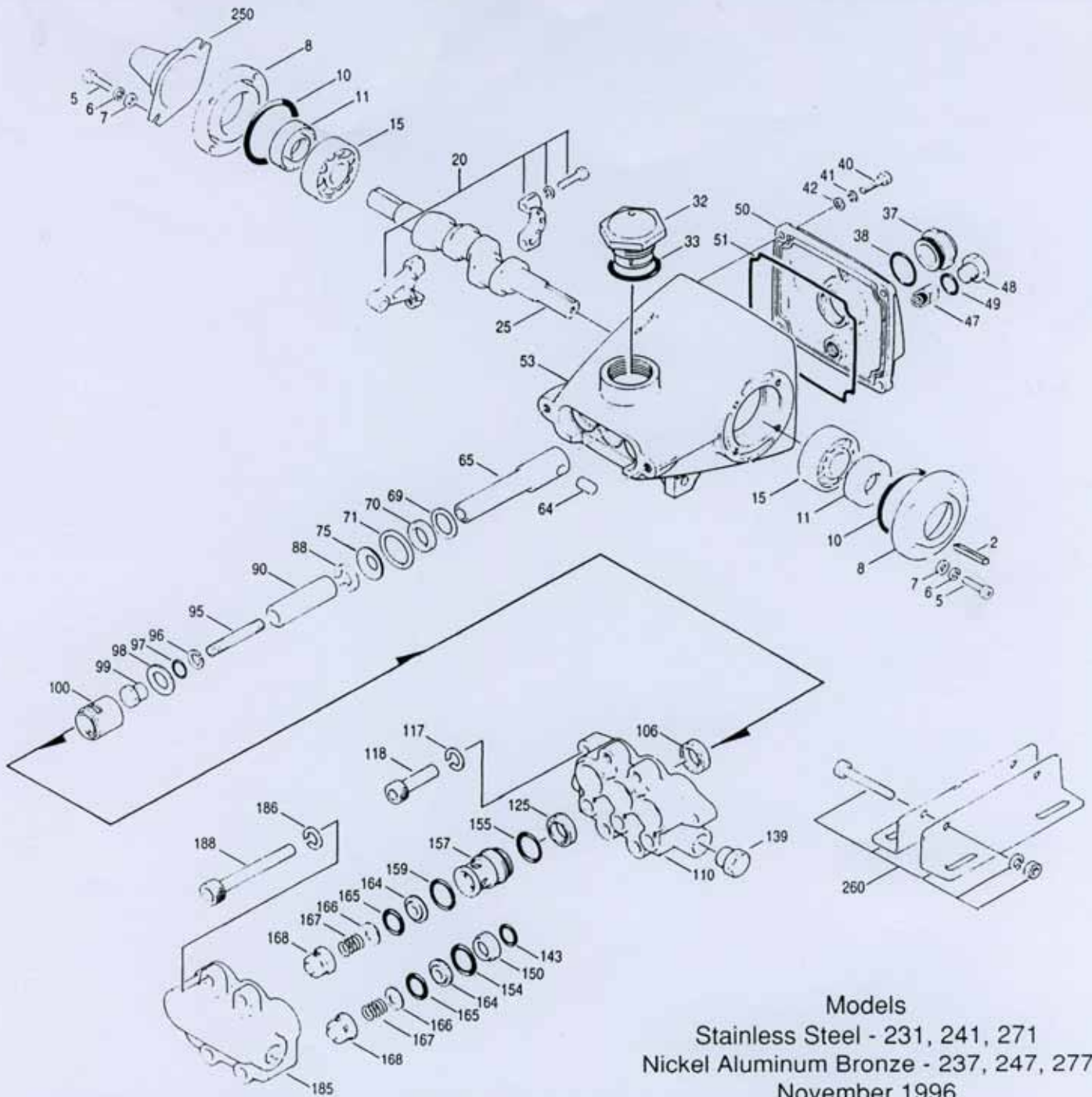

Models
 Stainless Steel - 231, 241, 271
 Nickel Aluminum Bronze - 237, 247, 277
 November 1996

278	30632	30632	30632	Flexible Coupling Assy (M16.5 to 5/8")	1
	34032	34032	34032	Flexible Coupling Assy (M16.5 to 1-1/8")	1
299	815262 N	815262 N	815262 N	Complete Head	1
	814823 SS	814823 SS	814823 SS	Complete Head	1
306	30983 B	30983 B	30983 B	Seal Kit (Incls: 97,106,125,143,154,155, 159, 165)	1
	33914 E	33914 E	33914 E	Seal and O-Ring Kit (97,106,125,143,154,155,159,165)	1
	33915 H	33915 H	33915 H	Hi-Temp Seal Kit (97,106,125,143,154,155,159,165)	1
	33609 V	33609 V	33609 V	Seal and O-Ring Kit (Incls: 97,106,125,143,154,155,159, 165)	1
310	30982	30982	30982	Valve Kit (Incls: 143,154,155,164,165,166,167,168)	1
350	30696	30696	30696	Valve Seat Removal Tool	1
351	43257	43257	43257	Seal Case Removal Tool	1
390	—	—	—	C.A.T. (For R.O. or Industrial Applications)	1
391	—	—	—	Adapter (2 per C.A.T.) (See Data Sheet for complete selection)	2

Bold printed part numbers are standard and unique to a particular pump model. Italics are optional items.

See Tech Bulletins 03, 08, 24, 33, 34, 36, 43, 47, 49, 52, 53, 67, 73 and 74 for additional information.

Pressurized Inlet and C.A.T. highly recommended for Hi-Temp, R.O. and industrial applications. Add 3000 to part number for Hi-Temp modes.

MATERIAL CODES (Not Part of Part Number)

A=Aluminum B=Buna-N CC=Ceramic E=EPDM G=Gunmetal (ALBZ) H=Hi-Temp N=Nickel Aluminum Bronze P=PVDF S=304SS SS=316SS T=Teflon V=Viton ZZ=Zamak